

Loewe **klang bar5 mr**



DE Umfassendes Benutzerhandbuch
EN Comprehensive user guide
NL Uitgebreide gebruikershandleiding
FR Guide de l'utilisateur complet
IT Guida utente completa
ES Guía completa del usuario
PT Guia exaustivo do utilizador
PL Kompleksowa instrukcja obsługi
CS Kompletní uživatelská příručka
SK Komplexná používateľská príručka
LV Visaptveroša lietotāja rokasgrāmata
LT Bendrasis naudojimo vadovas
ET Üldine kasutusjuhend

DA Omfattende brugervejledning
SV Omfattande användarhandbok
FI Kattava käyttöopas
NO Detaljert bruksanvisning
HR Sažeti vodič za korisnike
SL Popoln uporabniški priročnik
SQ Udhëzues gjithëpërfshirës i përdoruesit
RO Ghid de utilizare detaliat
EL Συνοπτικός οδηγός χρήσης
RU Общее руководство пользователя
UK Докладний посібник користувача
AR دليل الاستخدام الشامل

TR Kapsamlı kullanım kılavuzu
HE מודריך מקיף למשתמש
BG Подробно ръководство на потребителя
HU Átfogó felhasználói útmutató
SR Kompletan korisnički vodič
BS Detaljni korisnički priručnik (vodič)
KK Толык пайдаланушы нұсқаулығы
KA მომხმარებლის სრული სახელმძღვანელო
AZ Hərtərəfli istifadəçi təlimatı
HY Օգտագործման համապարփակ ուղեցույց

LOEWE.

Thank you

for choosing a Loewe product. We are happy to have you as a customer. At Loewe, we combine the highest standards of technology, design and user friendliness. This applies equally for TV, video, audio and accessories. Neither technology nor design accomplishes an end in itself, but together should facilitate the highest possible audio and visual experience for our customer.

Our design has not even been guided by short-term, fashionable trends. Because after all, you have purchased a piece of high-quality equipment, that you want to enjoy tomorrow and the next day.

Content

Scope of delivery	13
Position of the rating plate	13
Important safety instructions	14
Remote control	16
Main unit Components.....	17
Subwoofer components.....	18
Placement	18
Connecting the soundbar	18
Multi-room audio	20
Chromecast built-in.....	20
Basic Operation	20
AUX / OPTICAL / COAXIAL / HDMI Operation.....	21
Bluetooth Operation	22
USB Operation	22
Spotify	22
Software update.....	22
Troubleshooting	23
Technical data	24
Disposal	24

Scope of delivery

Carefully unpack the device and make sure all accessories are present:

- Soundbar
- Wireless subwoofer
- 2 x Power cable
- HDMI cable
- Remote control (incl. 2 x CR2032 batteries)
- User guide

Position of the rating plate

Labels with model number and operating voltage can be found on the bottom of the product.

1 Important safety instructions

Attention: Read this page carefully to ensure safe operation of the device.

Follow all safety and operating instructions when using this product.

You should keep the safety and operating instructions for future reference.

You should strictly follow all warnings provided on the product and listed in the operating instructions.

Explanation of symbols



Double Insulated (Class II) Equipment. This electrical appliance has been designed in such a way that it does not require a safety connection to electrical earth (ground).



This symbol indicates risks caused by high voltages.



This symbol is to alert the user to other, more specific risks.



This symbol indicates dangers caused by the development of fire.

1.1 Installation

1.1.1 Placement

Place the unit on a stable, even surface.

Do not place this unit close to strong magnetic fields.

1.1.2 Cables

Lay the power cables so that they cannot be damaged. The power cable may not be kinked or laid over sharp edges, stood on or exposed to chemicals; the latter also applies to the system as a whole. A power cable with damaged insulation can cause electric shocks and poses a fire risk. As such, it must be changed before the unit is used again.

1.1.3 Do not use this device near water



The device should never be exposed to water droplets or water splashes, such as those found near a bathtub, wash basin, kitchen sink, washing machine, wet basement or swimming pool. Never place containers filled with liquids, such as e.g. flower vases, on the device.

1.1.4 Ventilation



Slots and openings in the housing are used to ventilate the device to ensure reliable operation of the device and to protect the device from overheating. Do not block the ventilation holes. Install the device according to the manufacturer's instructions. Never block the ventilation holes by placing the device on a bed, sofa, rug, or similar soft surfaces. This device should not be installed in a bookshelf or built-in wardrobe unless adequate ventilation is ensured.

1.1.5 Heat



Do not install the device near hot surfaces, such as radiators, fan heaters, stoves or other devices (including amplifiers) that can be hot. Never place objects with open flame, such as candles or lanterns, on or near the device. The installed batteries should not be exposed to excessive heat such as direct sunlight, fire or the like.

1.1.6 Accessories

Use only the accessories specified by the manufacturer.

1.1.7 Network connection

Please make sure that the firewall function is activated at your network access point (router). Consult your router's instruction manual.

1.2 Usage

1.2.1 Intended use

This device is intended exclusively for the reception and playback of sound signals.

1.2.2 Remote control

Exposing the remote control sensor to direct sunlight or high-frequency fluorescent light may cause malfunction. In such cases, you should move the system to a different location to avoid such malfunction.

The supplied batteries are intended for functional testing and may have a limited lifetime. If the range of the remote control decreases, replace the old batteries with new ones.

1.2.3 Overload



Never overload mains sockets, extension cords or multiple sockets, otherwise there is a risk of fire or electric shock.

1.2.4 Thunderstorm



The device should be disconnected from the mains during thunderstorms and if it is not used for a long time.

1.2.5 Penetration of foreign material and liquid



Be careful not to allow foreign material or liquid to enter this device through ventilation holes, otherwise it may come into contact with high voltage components or short circuit resulting in a fire or electric shock. Never spill liquids of any kind on this device.

1.2.6 Risks associated with high volume



The device is not designed for listening with headphones. To prevent possible hearing damage, do not listen at high volume for long periods.

1.2.7 Disconnection from power supply

The power button does not completely disconnect the power supply in any position. To completely disconnect the device from the mains, unplug the mains cable from the socket.

The mains plug must be easily accessible so that the unit can be disconnected from the mains at any time.

1.3 Maintenance

1.3.1 Device maintenance

Never attempt to carry out the maintenance of this device yourself, because live parts can be exposed through the openings or by removing covers, contacting which can be hazardous. Leave all maintenance to qualified service personnel.

1.3.2 Clean only with a dry cloth!

Unplug the mains adapter of this device from the mains socket before cleaning this product. Never use liquid cleaning detergents or cleaning sprays. Use only a damp cloth for cleaning.

1.4 Batteries

Caution! Do not ingest battery!



The remote control supplied with this product contains a coin cell battery. If the coin cell battery is swallowed, it can cause severe internal burns in just 2 hours and can lead to death.

Keep new and used batteries away from children.

If the battery compartment does not close securely, stop using the product and keep it away from children.

If you think batteries might have been swallowed or placed inside any part of the body, seek immediate medical attention.



Caution!

Risk of explosion if the batteries are replaced with the wrong type.

Do not heat or disassemble batteries. Never throw batteries into fire or water.

Do not carry or store batteries with other metallic objects. The batteries could short circuit, leak or explode.

Never recharge a battery unless it is confirmed to be a rechargeable type.

When the Remote Control is not to be used for a long time (more than a month), remove the battery from the Remote Control to prevent it from leaking.

If the batteries leak, wipe away the leakage inside the battery compartment and replace the batteries with new ones.

Do not use any batteries other than those specified.

EU Declaration of Conformity

Hereby, Loewe Technology GmbH declares that the radio equipment type Loewe klang bar5 mr complies with Directive 2014/53/EU. The full text of the EU declaration of conformity is available at the following Internet address: <https://www.loewe.tv/de/support>

This product can be used across all EU member states.

Due to the 5 GHz frequency range of the built-in WLAN module, use in the following countries is only permitted inside buildings:

AT	BE	BG	CZ	DK	EE	FR	DE	IS	IE	IT
EL	ES	CY	LV	LI	LT	LU	HU	MT	NL	NO
PL	PT	RO	SL	SK	TR	FI	SE	CH	UK	HR

english

1.5 Repair

1.5.1 Damages requiring repair

Maintenance and repair work should only be carried out by a qualified customer service. Maintenance/repair is required if the device has been damaged (e.g. the mains adapter) if liquid has entered the device, if objects have entered the device, if the device has been exposed to rain or moisture, when it stops working properly or has fallen down.

1.5.2 To minimize the risk of electric shock, fire, etc.

Do not remove screws, covers or body parts.

1.6 Automatic energy saving function

The device is equipped with an automatic energy saving function. This switches the device to standby mode within 15 minutes if it is played at a very low volume or if the device is muted. Please note that the setting can't be changed.

2

Remote control

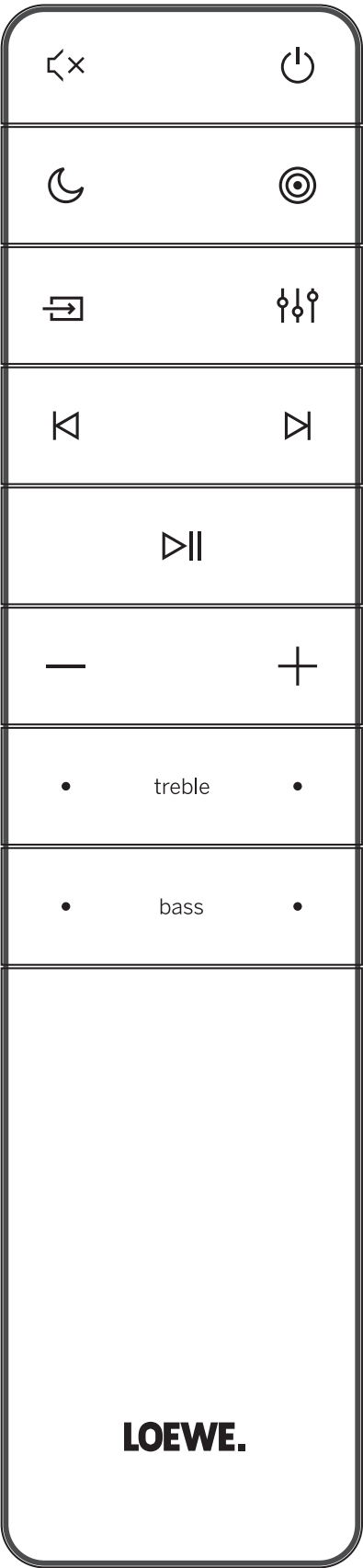

	Sound Mute / Unmute.
	Switches the soundbar on or switches to standby mode.
	Turns on/off the night mode.
	Press and hold to turn the display on / off (off by default). This feature displays additional information on the front panel display in certain situations.
	Switches between surround sound modes.
	Press and hold to open the volume setting for external speakers.
	Press to change input source.
	Press and hold in standby mode to show the software version on the display.
	Equaliser - choose from pre-set audio modes: OFF, SPEECH, CLASSICAL, POP, CUSTOM FILM, CUSTOM MUSIC.
	Skip to the previous audio track in USB / Bluetooth / PLAY-Fi mode.
	Skip to the next audio track in USB / Bluetooth / PLAY-Fi mode.
	Play/pause audio track in USB / Bluetooth / PLAY-Fi mode.
	Press and hold for 8 seconds in standby mode to restore the factory settings. Press and hold to activate the pairing function in the Bluetooth mode or disconnect the existing paired Bluetooth device.
	Reduce volume level.
	Increase volume level.
treble	Adjusts the treble level.
bass	Adjusts the bass level.

First time use

The unit has a pre-installed lithium 2 x CR2032 battery. Remove the protective tab to activate the remote control battery.

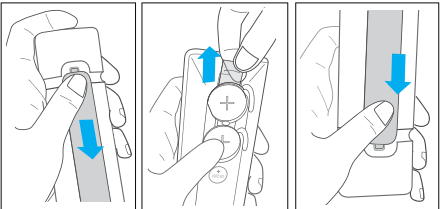

1. Press and slide the back cover to open the battery compartment of the remote control.
2. Remove the protective tab.
3. Push the battery cover back into place.

Replacing the remote control batteries

The remote control requires 2 pcs of CR2032, 3V Lithium battery. Press and slide the back cover to open the battery compartment of the remote control.

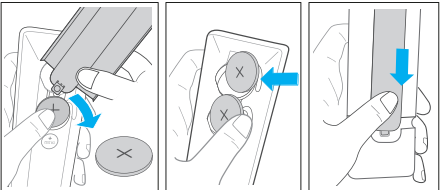

1. Use a tool (such as the battery compartment cover) to pry up the groove between the two batteries to remove the old batteries.
2. Insert the new batteries from the side and push them firmly into the original battery position. Make sure the (+) side of the battery is facing up.
3. Push the battery cover back into place



3 Main unit Components

3.1 Main unit front panel

1.  (Standby) button/indicator – Switches the soundbar on or switches to standby mode.

LED indicator colour information

LED colour	Status
White	Standby mode
Light is off	Soundbar is on and nothing is playing
Green	Receiving PCM track / AUX mode
Blue	Bluetooth mode
Turquoise	Decoding Dolby Audio track
Purple	Decoding Dolby Atmos track
Red	Decoding DTS/DTS:X track
Yellow	USB mode / MP3 playback
Orange	Play-Fi / Multiroom mode

2.  (Source) button - Press to change input source.
Press and hold in standby mode to show the software version on the display.
3.  (Play/Pause) button - Play/pause audio track in USB / Bluetooth / PLAY-Fi mode.
Press and hold for 8 seconds in standby mode to restore the factory settings.
Press and hold to activate the pairing function in Bluetooth mode or disconnect the existing paired Bluetooth device.

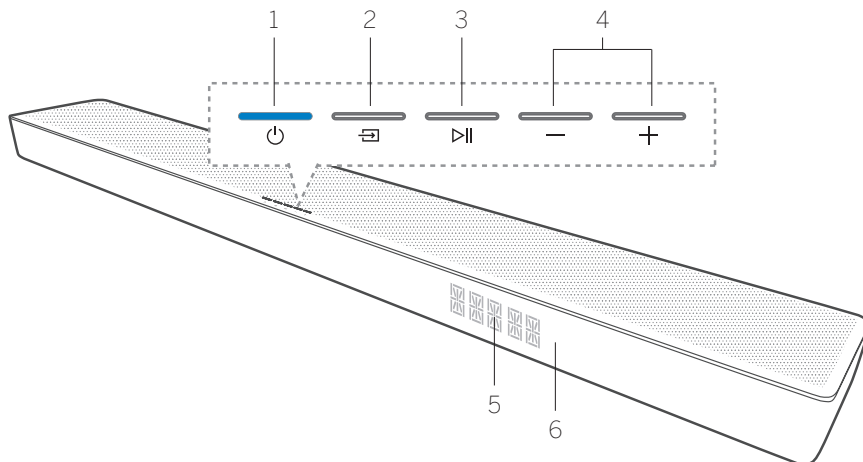

4.  -/+ (Volume) button – Reduces/increases the volume level.
Press both buttons simultaneously to mute / unmute the soundbar.
6. Remote control sensor - Point the remote control at the remote control sensor to operate the system.
5. Front panel display

3.2 Main unit rear panel

Multichannel

1. Rear flap – You will need to remove the rear flap of your Sound Bar before using WDAL 2.0 control keys.
2. WDAL 2.0 control keys - Use these switches to connect additional external wireless speakers via the WDAL2.0 as SUB / REAR / FRONT / CENTRE channel. Set the switch to SMALL for small speakers, LARGE for large speakers. To disconnect the speaker for a specific channel, set the switch to OFF.
3. PAIRING button - for WDAL 2.0 pairing

Multiroom

4. WPS (Wi-Fi Protected Setup) button/indicator – Triggers Wi-Fi setup for Play-Fi. Press and hold the button for 3 seconds to activate the WPS mode.
Press and hold the button for 8 seconds to activate the AP mode.

LED indicator state	Status
LED slowly pulsing	Wi-Fi Access Point (AP) mode
LED flashes twice	Wi-Fi Protected Setup (WPS) mode
LED is on	Connected / Pairing successful

5. AUX IN – connect to the audio source via 3.5mm audio cable.
6. USB – connect a USB storage device.
7. HDMI OUT (TV eARC/ARC) – connect to the HDMI jack on a TV.

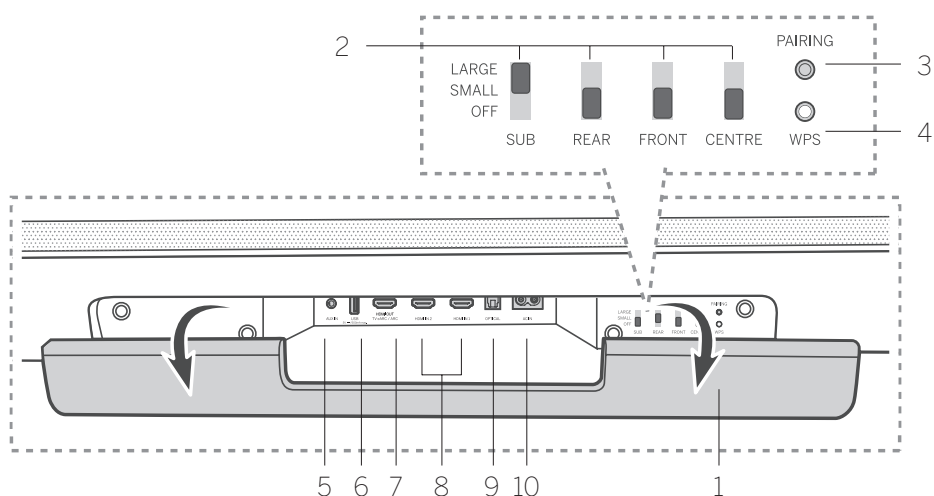

8. HDMI IN 1 / HDMI IN 2 – connect to the HDMI output of an external devices (e.g. game consoles, DVD and Blu-ray players).
9. OPTICAL – connect to the digital (optical) output of an external device.
10. AC IN – connect to the power supply.

4 Subwoofer components

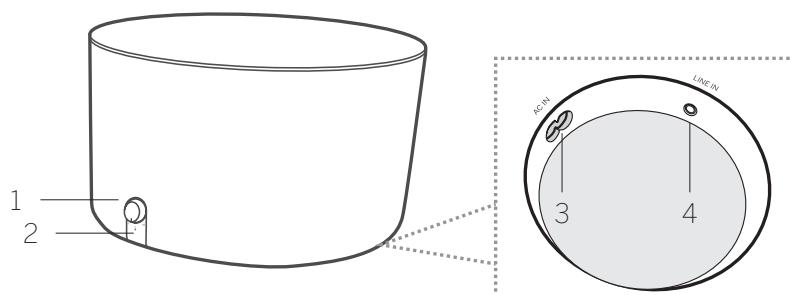

1. Volume knob
Rotate to adjust the bass level.
Press and hold to enter the pairing mode.
2. Subwoofer LED indicator

LED indicator state	Status
LED flashes quickly	Subwoofer is in pairing mode
LED is on	Connected / Pairing successful
LED flashes slowly	Connection / Pairing failed

3. AC IN socket – connect to the power supply.
4. LINE IN socket – for connecting to an external audio device via 3.5mm audio cable.

5 Placement

Place the soundbar and subwoofer on a stable even surface.

Place the subwoofer at least 1 meter (3 feet) away from your soundbar, and 10 centimeters (4 inches) away from the wall. We recommend the front area of the room in a way that the basses can freely flow to the sides.

Place the soundbar on a table underneath the TV.

Below is an example of the correct placement.

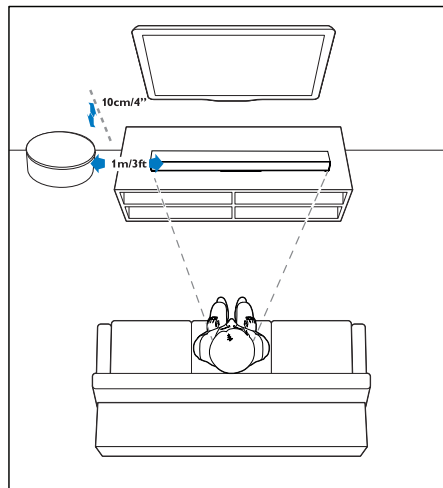

6 Connecting the soundbar

Before you make or change any connections, make sure that all devices are disconnected from the power outlet.

6.1 Dolby Atmos®

Dolby Atmos® gives you immersive listening experience by delivering sound in three dimensional space, and all the richness, clarity, and power of Dolby sound.

For more information, please visit dolby.com/technologies/dolby-atmos

For using Dolby Atmos®

Dolby Atmos® is available only in HDMI mode.

For the details of the connection, please refer to "Connecting with HDMI" chapter.

1. To use Dolby Atmos® in HDMI 1 / HDMI 2 / HDMI ARC mode, your TV has to support Dolby Atmos®.
2. Make sure that "No Encoding" is selected for bitstream in the digital audio output of the connected external device (e.g. Blu-ray, TV etc.).
3. While entering Dolby Atmos / Dolby Digital / PCM format, the Soundbar will show DOLBY ATMOS / DOLBY AUDIO / PCM AUDIO / DOLBY SURROUND.

Note

The full Dolby Atmos® experience is only available when the Soundbar is connected to the source via a High Speed HDMI cable.

Dolby formats appear on the front panel display only when the display function is turned on. Press and hold  to turn on / off the display function.

The Soundbar will still function when connected via other methods (such as a Digital Optical cable) but these are unable to support all of the Dolby features. Given this, our recommendation is to connect via HDMI, in order to ensure full Dolby support.

6.2 Connecting with HDMI

Some 4K HDR TVs require the HDMI input or picture settings to be set for HDR content reception. For further setup details on HDR display, please refer to the operating instructions of your TV.

Option 1 - eARC/ARC (Audio Return Channel)

Your Soundbar supports HDMI with Audio Return Channel (eARC/ARC). If your TV is HDMI ARC compliant, you can hear the TV audio through your Soundbar by using a single HDMI cable.

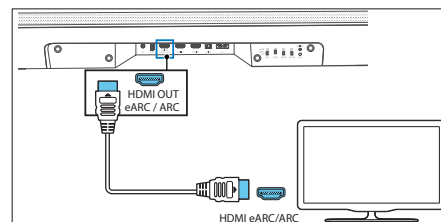

1. On your TV, turn on HDMI-CEC operations.
2. Using a High Speed HDMI cable (included), connect the HDMI OUT (TV eARC/ARC) connector on your Soundbar to the HDMI ARC connector on the TV. The HDMI ARC connector on the TV might be labeled differently. For details, see the TV user manual.
3. "ARC" appears on the display of the soundbar and the soundbar plays the TV sound. When the TV sound is not output, press the  (Source) button repeatedly until you see "ARC" on the display and TV sound is played.

When HDMI ARC connection is properly set up, you can enjoy these features:

- The soundbar turns on automatically when you turn on the TV.
- The soundbar turns off automatically when you turn off the TV.
- You can mute/unmute or adjust the volume of the soundbar using the TV remote control.

Note

- Your TV must support the HDMI-CEC and ARC function. HDMI-CEC and ARC must be set to On.
- The setting method of HDMI-CEC and ARC may differ depending on the TV. For details about ARC function, please refer to your TV operating instructions.
- Only cables compatible with HDMI version 1.4 or higher can support the ARC function.

Option 2 - Standard HDMI

If your TV is not HDMI ARC-compliant, connect your Soundbar to the TV through a standard HDMI connection.

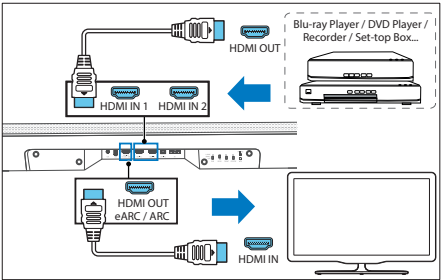

1. Use an HDMI cable to connect the Soundbar's HDMI IN (1 or 2) connector to your external devices (e.g. game consoles, DVD players and blu-ray).
2. Use an HDMI cable to connect the Soundbar's HDMI OUT (TV eARC/ARC) connector to the TV's HDMI IN connector.

Note

This connection option allows only playback of video/ audio from external devices connected directly to the HDMI 1 or 2 inputs on the soundbar. If your TV does not have an HDMI ARC connector and you wish to play sound from TV on the soundbar, you will need to use alternative connection (e.g. Optical or Analogue).

6.3 Connecting with an optical cable

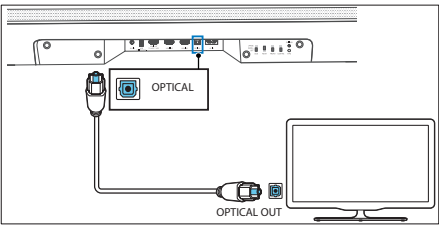

Using an optical cable (not included), connect the OPTICAL connector on your soundbar to the OPTICAL OUT connector on the TV or other device.

- The digital optical connector might be labeled SPDIF or SPDIF OUT.

6.4 Connecting with an analogue audio cable

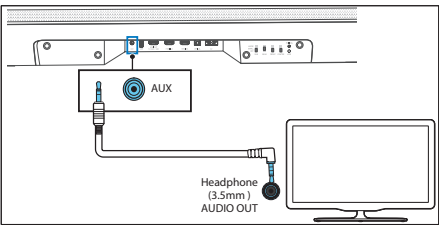

Option 1

Use a 3.5mm to 3.5mm audio cable (not included) to connect the TV's or external audio device headphone socket to the AUX IN socket on the unit.

Option 2

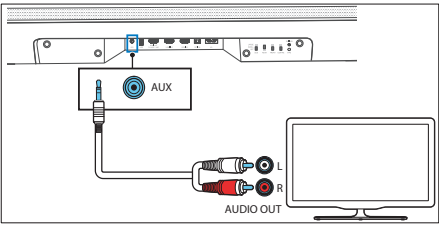

Use an RCA to 3.5mm audio cable (not included) to connect the TV's audio output sockets to the AUX IN socket on the unit.

6.5 Connecting the power

Note

- Before connecting the AC power cord, ensure you have completed all other connections.
- Risk of product damage! Ensure that the power supply voltage corresponds to the voltage printed on the underside of the unit.

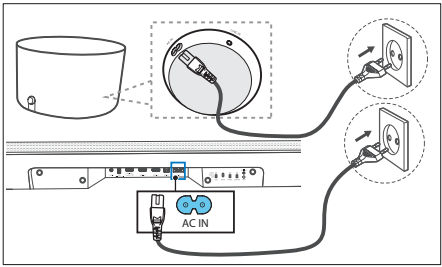

1. Connect the mains cable to the AC IN Socket of the soundbar and then into a mains socket.
2. Connect the mains cable to the AC IN Socket of the subwoofer. Secure the cable to the cable management compartment on the bottom side of the subwoofer. Finally, plug the power cable to the mains socket.

6.6 Connecting the subwoofer

Automatic Pairing

The subwoofer provided is a WDAL 2.0 device. This means that for the subwoofer to work, the WDAL 2.0 switch labelled SUB must be set to SMALL or LARGE. Remove rear flap from soundbar and check the position of the SUB switch. If it is in OFF position, please change its position to SMALL or LARGE.

Plug the soundbar and the subwoofer into the mains sockets and then press on the unit or remote control to switch the unit to ON mode. The subwoofer and soundbar will automatically pair.

- Determine the status based on the wireless subwoofer indicator.

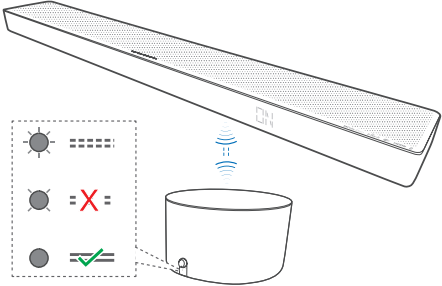

LED indicator state	Status
LED flashes quickly	Subwoofer is in pairing mode
LED is on	Connected / Pairing successful
LED flashes slowly	Connection / Pairing failed

Note

Do not press volume knob on the rear of the subwoofer, except for manual pairing.

Manual Pairing

If no audio from the wireless subwoofer can be heard, pair the subwoofer manually.

1. Unplug both units from the mains socket, then plug them in again after 3 minutes.

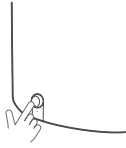

2. Press and hold the Volume knob on the rear of the subwoofer for 5 seconds.

- The pairing indicator on the subwoofer will flash quickly.

3. Press and hold  for 5 seconds on the unit or remote control to switch the unit to ECO STANDBY mode.

4. Then press  on the unit or remote control to switch the unit ON.

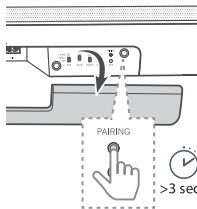

5. Remove the rear flap of the soundbar, then press the PAIRING button for 5 seconds.

6. The pairing indicator on the subwoofer will light up after success.

- If the pairing indicator still flashes, please repeat the above steps.

Note

- The subwoofer should be within 6 m of the soundbar in an open area (the closer the better).
- Remove all objects between the subwoofer and the soundbar.
- If the wireless connection fails again, check the area for conflict or strong interference (e. g. interference from an electronic device). Eliminate these conflicts or strong interferences and repeat the above procedure.

6.7 Multiroom: Connecting to Wi-Fi

WPS mode

If your router has Wi-Fi Protected Setup (WPS), you can set up the connection without entering a password.

1. Press and hold the WPS button for 4 seconds. You will hear a tone and the Wi-Fi indicator will flash twice continuously.
2. Press the WPS button on your router. The button is usually marked with the WPS logo.

Note

- WPS is not a standard feature of all routers. If your router does not have WPS, follow standard Wi-Fi setup.
- Press the WPS button once if you want to exit the WPS mode or it will automatically exit after 2 minutes.

Airplay setup

Use AirPlay to set up the Wi-Fi connection of iOS device (iOS7 or later) and soundbar.

1. Press and hold the **WPS** button located at the rear side of soundbar for 8 seconds to trigger the Wi-Fi connection until the speaker makes a second tone, and then release the button.
2. Wait until the Wi-Fi light indicator turns from a fast blink to a slow pulse. A slow pulse indicates that the speaker is entering the Wi-Fi setup mode.
3. On your iOS device go to **Settings > Wi-Fi > select network [Play-Fi device (xxxxxx)]**
4. Soundbar will be automatically recognized as Air-play device. Tap on [Set up new AirPlay speaker].
5. Tap on [Show Other Networks...] and select your home network to which you want soundbar to connect.
6. After a successful Wi-Fi connection, the Wi-Fi light indicator stops pulsing and stays on. After setting up this product on your Wi-Fi network, you can control it from any smartphone or tablet on the same network.

Google Home setup

1. Download the Google Home app on your mobile device.
2. iPhone/iPad only: Turn on your mobile device's Bluetooth.
3. Press and hold the WPS button located at the rear side of soundbar for 8 seconds to trigger the Wi-Fi connection until the speaker makes a second tone, and then release the button.
4. Wait until the Wi-Fi light indicator turns from a fast blink to a slow pulse. A slow pulse indicates that the speaker is entering the Wi-Fi setup mode.
5. Open the Google Home app.
6. Follow the steps to set up your device.

If you can't find the steps to set up your soundbar:

- At the top left of the Google Home app home screen, tap **Add + > Set up device > New device**.
- Follow the setup steps.

7 Multi-room audio

This soundbar can be used as part of multi-room speaker setup. This means that the same music can be played from your soundbar and other compatible speakers simultaneously throughout your home.

To use this feature, make sure the soundbar and your smartphone / tablet are on the same network. You can use Google Home, Airplay 2 or DTS Play-Fi app to control compatible multi-room speakers. You can then play the music on multiple speakers at the same time, assign speakers to different groups, control the volume individually, or use master volume to change the volume on all speakers at the same time.

8 Chromecast built-in

This soundbar supports Chromecast built-in feature that allows you to cast music from Chromecast compatible apps to your soundbar. To use this feature, make sure the soundbar and your smartphone / tablet are on the same network. Start playing music on a Chromecast-enabled app and cast it to your soundbar simply by tapping the  (cast) button and selecting the soundbar from the list.

9 Basic Operation

9.1 Turn ON and OFF

When you first connect the unit to the mains socket, the unit will be in STANDBY mode. The STANDBY indicator will light up white.

Auto Standby

The unit will automatically switch to standby mode after about 15 minutes if the TV or the external device is disconnected (or USB, Bluetooth, Play-Fi function playback is paused) or turned off.

Automatic Wake up

If the unit is connected to the TV or external device with an HDMI cable, the unit turns on automatically when the TV or external device is turned on.

Note

- For automatic wake up to work, the TV or external device must support HDMI CEC function and must be activated. Read the operating instructions of your TV/external device.



9.2 Multiroom mode

By pressing  (Standby) on the soundbar or remote control while soundbar is on, it will enter default standby mode. In this standby mode all network functions will be turned off.

It is possible to activate the multiroom mode, where Wi-Fi is always on and Play-Fi and AirPlay2 are also available. This mode is recommended if you want to use the soundbar as a Play-Fi device that can be woken up remotely at any time.

In standby mode, press  (Night) ->  (Surround) ->  (Night) on the remote control to switch on the multiroom mode.



From now on, each time you turn off the soundbar, it will enter the multiroom mode. Please note that multiroom mode has higher power consumption than standard standby.

To reactivate standard standby mode again, press  (Night) ->  (Surround) ->  (Night) on the remote control.

9.3 Input mode

Press the  (Source) button repeatedly on the unit or on the remote control to select BT (Bluetooth), HDMI 1, HDMI 2, ARC, OPT (Optical), AUX, USB mode. The display shows the selected mode.

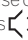
9.4 Volume control

Press +/- (Volume) to increase or decrease a volume level. To mute the sound, press  (Mute). To restore the sound, press  (Mute) again or press +/- (Volume).

9.5 Equalizer effect

Press the  (Equalizer) button on the remote control to select the desired pre-set equaliser effect: OFF, SPEECH, CLASSICAL, POP, CUSTOM MUSIC, CUSTOM FILM.

9.6 Bass/Treble Level

Press the bass +/- buttons on the remote control to adjust bass level (BAS -12 ~ BAS +12).

Press the treble +/- buttons on the remote control to adjust treble level (TRB -12 ~ TRB +12).

9.7 Surround Sound Mode

Experience immersive audio in surround mode.

Press the  (Surround) button on the remote control to change the surround mode.

9.8 Night Mode

Press the  (Night) button on the remote control to turn on/off night mode. This function ensures that there is less range between quiet and loud sounds in movies. Recommended for late night listening.

9.9 Display Brightness

If you do not press any button for 10 seconds, the display will turn off automatically. Pressing any button restores the brightest level.

9.10 Factory Reset

Resets the device to the default settings. In standby mode, press and hold the  button for 8 seconds. "RESET" appears on the display and the device returns to the original settings.

9.11 WDAL 2.0 control

Remove the rear flap of your soundbar before using the WDAL 2.0 control keys.

Use these switches to connect additional external wireless speakers via the WDAL2.0 as SUB / REAR / FRONT / CENTRE channel. Set the switch to SMALL for small speakers, LARGE for large speakers. To disconnect the speaker for a specific channel, set the switch to OFF.



Connecting the subwoofer

The subwoofer provided is a WDAL 2.0 device. This means that for the subwoofer to work, the WDAL 2.0 switch labelled SUB must be set to SMALL or LARGE.

Connecting another WDAL 2.0 device

You can wirelessly connect up to 6 additional speakers that support WDAL 2.0 to the soundbar. To connect a WDAL 2.0 compatible speaker to the soundbar, you must:

1. Press the PAIRING button on the soundbar. To access the PAIRING button, you must remove the rear flap on the soundbar.
2. Press the PAIRING button on the WDAL 2.0 speaker.



3. Set the speaker role on the speaker itself. Options: Front left, Front right, Centre, Rear left, Rear right.
4. Depending on the type of speaker, set the WDAL 2.0 switch corresponding to the selected speaker role to SMALL or LARGE.

For details on setting the external speaker to pairing mode, changing its role, and whether to select SMALL or LARGE on the soundbar switch, please refer to the user manual of the speaker.

Note: If you switch the WDAL 2.0 switch on the soundbar from OFF to another position, the soundbar speakers of that channel will be turned off. So if you connect the Front External Speakers via WDAL 2.0, the speakers on the front channels of the soundbar will be turned off.

Volume offset

You can adjust the offset volume for external speakers connected via WDAL 2.0. This is useful if the character of your room does not allow the speakers to be evenly distributed and some speakers are much closer to the listener than others. You can adjust the overall volume of each speaker individually:

1. Press and hold  (Surround) button on the remote control. FL appears on the soundbar display.
2. Use  /  buttons to select a channel.
3. Use + / - button to change the volume offset of the selected channel.

Display abbreviations explained:

FL – front left speaker
FR – front right speaker
SL – rear left speaker
SR – rear right speaker
SUB – subwoofer
CEN – centre speaker

10 AUX / OPTICAL / COAXIAL / HDMI Operation

Make sure the unit is connected to a TV or audio device.

1. Press  (Source) button on the unit or remote control repeatedly to select HDMI 1, HDMI 2, ARC, OPT, AUX mode.
2. Control your TV/audio device directly for playback functions.
3. Press +/- button on the unit or remote control to adjust the volume to desired level.

Note

- If the soundbar is in HDMI 1 / HDMI 2 / ARC / OPT (Optical) mode and there is no sound output from it, you may need to activate PCM or Dolby Digital signal output on the source device (e.g. TV, DVD or Blu-ray player).
- The unit may not be able to decode all digital audio formats from the input source. In this case, the unit will be muted. This is not a defect. Make sure the audio setting of the input source connected via HDMI 1 / HDMI 2 / ARC / OPT (optical) input is set to PCM or Dolby Digital. For details on audio settings, refer to the user manual of the input source device.
- In HDMI mode, when DOLBY ATMOS audio format playback starts, "DOLBY ATMOS" appears on the audio panel display.
- When DOLBY DIGITAL audio playback starts, if surround sound is turned on, the soundbar display will display "DOLBY SURROUND". If surround sound is turned off, it will display "DOLBY AUDIO".
- When PCM audio format playback starts, "PCM AUDIO" appears on the soundbar display.
- When entering non-PCM or DOLBY DIGITAL audio formats, if there is no sound output from the unit, "ERROR" appears on the display.

11 Bluetooth Operation

Connect the soundbar to a Bluetooth device (such as an iPad, iPhone, iPod touch, Android phone, or laptop) via Bluetooth, and then you can listen to audio files stored on the device through the soundbar.

1. Press the  (Source) button on the unit or remote control repeatedly to switch the soundbar to BT (Bluetooth) mode.



NO BT is displayed on the display panel.

2. Turn on Bluetooth on the Bluetooth device, search for and select "Klang bar5 mr" to connect. For information on enabling Bluetooth, see the user guide of the Bluetooth device.
3. Wait until you hear the voice prompt from the soundbar.

If the successfully connected, BT will appear on the display panel.

Select and play audio files or music on your Bluetooth device.

If a call is made during playback, the music pauses. When the call is completed, playback resumes.

If your Bluetooth device supports AVRCP profile, you can press  /  on the remote control to skip a track or press  to pause/resume playback.

4. To exit Bluetooth, select another source.

When you switch back to Bluetooth mode, the Bluetooth connection is re-established.

To connect the soundbar to another Bluetooth device, press and hold the  button on the remote control to disconnect the currently connected Bluetooth device.

Note





- The minimum requirements for a Bluetooth device are: Bluetooth profile A2DP, AVRCP and Bluetooth version 4.2 + EDR
- The maximum operating range between the soundbar and a Bluetooth device is approximately 10 meters.
- Compatibility with all Bluetooth devices is not guaranteed.
- The music streaming may be interrupted by obstacles between the device and soundbar, such as wall, a metal case covering the device, or other devices in the vicinity that operate on the same frequency.

12 USB Operation

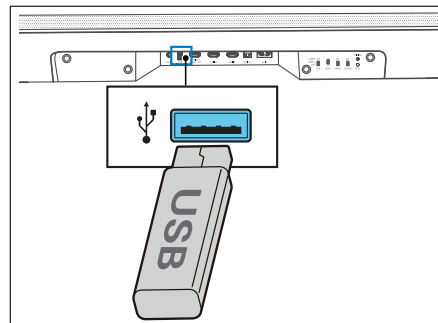
Enjoy audio on a USB storage device, such as an MP3 player or USB flash memory, etc.

1. Insert the USB device.



2. Press  (Source) on the unit or remote control repeatedly to select the USB mode.
3. During playback, press  to start / pause / resume playback. Press  /  to skip to the previous or next track.

Note

This product may not be compatible with certain types of USB storage devices.

- If you use a USB extension cable, USB hub or USB multifunctional card reader, the USB storage device may not be recognized.
- Do not remove the USB storage device while reading files.
- The unit can support USB devices with up to 32 GB of memory.
- This unit can play MP3.

13 Spotify

Use your phone, tablet or computer as a remote control for Spotify. Go to spotify.com/connect to learn how.

The Spotify Software is subject to third party licenses found here:

www.spotify.com/connect/third-party-licenses

14 Software update

To upgrade soundbar firmware:

1. Download the latest software from the website.
2. Extract the file to the USB root folder.
3. Connect USB to the soundbar while in power-on mode.
4. The installation starts and the display shows the update progress from 0 to 99.

Warning: It may take a few minutes for the software to update. Do not unplug your speaker, turn off the device, or disconnect the USB stick or network during the update. These actions can potentially destroy your soundbar.

5. When the update is complete, the display turns off.
6. Disconnect the soundbar from the mains.
7. After one minute, connect the soundbar back to the mains.

The soundbar is now updated to the new software version.

To upgrade the multi-room function of your soundbar:

1. Download and install the DTS Play-Fi app on your mobile device.
2. Connect the soundbar to the app.
3. If new Play-Fi software is available, the application notifies you.
4. Follow the instructions in the application to run the multi-room feature update.

Warning: It may take a few minutes for the software to update. Do not unplug your speaker, turn off the device, or disconnect the USB stick or network during the update. These actions can potentially destroy your soundbar.

Apps

Scan the QR code below with your phone and download the recommended app.



"my Loewe" is an entry point to the Loewe world and gives you access to all user manuals for your Loewe products.

Troubleshooting

In the event of a device failure, we recommend that you check the list below before calling the helpline.

Problem	Possible cause	Remedy/notes
The system does not respond to button press	A software error may have caused the device to stop receiving commands from the buttons, and the device must be restarted by unplugging it.	Unplug the unit from the power supply for a few minutes, then plug it in again.
No sound from the soundbar.	<ul style="list-style-type: none"> a. Incorrect source input is selected b. The soundbar is muted c. A software error may have caused this problem. d. The soundbar cannot decode the input audio signal e. Some or all of the WDAL2.0 switches are in the incorrect position. 	<ul style="list-style-type: none"> a. On the remote control, select the correct audio input. b. Press the MUTE button c. Reset the unit to factory settings (see chapter "Basic Operation") d. Try to change Digital output settings on source device to PCM. e. If you do not have any external speakers connected, make sure all the switches on the rear are set to OFF and the SUB switch is set to SMALL or LARGE.
No sound from the wireless subwoofer.	<ul style="list-style-type: none"> a. Automatic pairing failed b. The volume is too low c. The subwoofer switch on the back of the soundbar is set to OFF. 	<ul style="list-style-type: none"> a. Pair the subwoofer manually b. Increase the volume. Press the + button on the sound bar or on the remote control. c. On the back of the soundbar, change the position of the SUB switch to SMALL or LARGE.
The subwoofer is idle or the subwoofer indicator does not light.	A software error may have caused this problem.	Unplug the power cord and plug it in again after 3 minutes, to reset the subwoofer.
Distorted sound or echo.	The TV speakers may cause echo if they are not synchronized with the sound of the soundbar.	If you play TV audio through this product, make sure the TV is muted.
A Bluetooth device cannot connect to the soundbar.	<ul style="list-style-type: none"> a. The device does not support compatible profiles required for the soundbar. b. You have not enabled the Bluetooth function of the device. c. The Soundbar is already connected to another Bluetooth device. 	<ul style="list-style-type: none"> a. Only devices with Bluetooth profile A2DP, AVRCP are compatible. b. For information on enabling this function, see the device user guide. c. Disconnect the connected device, then try again.
The audio playback quality of the connected Bluetooth device is poor.	Bluetooth reception is poor.	Move the device closer to the soundbar or remove obstacles between the device and the soundbar.
Wi-Fi connection cannot be established.	<ul style="list-style-type: none"> a. Wi-Fi network may be unavailable. b. Wi-Fi signal is very weak. c. You are entering an incorrect password. 	<ul style="list-style-type: none"> a. Check the availability of WLAN network on the router. b. Place the Wi-Fi router closer to the unit. c. Make sure that the password is correct.
Cannot achieve outstanding Dolby Atmos® effects.	For non-HDMI connections (such as USB, Bluetooth, OPTICAL or AUX), limited surround effects are generated.	For information on how to get the best Dolby Atmos effects, see the "Dolby Atmos®" chapter.
Cannot discover the Play-Fi supported device from the app.	Device may be disconnected from Wi-Fi.	Make sure the device is connected to the Wi-Fi.
Cannot play Play-Fi music.	<ul style="list-style-type: none"> a. Service or content has been terminated. b. First setup of soundbar failed. c. You have used the soundbar previously as Stereo Pairs or Surround Sound in the Play-Fi app. 	<ul style="list-style-type: none"> a. Certain network services or content available through the device may not be accessible in case the service provider terminates its service. b. If the first setting is not successful, close the DTS Play-Fi Application. Restart the application. c. If the speaker is set as Stereo Pairs or Surround Sound, it must be disconnected in the app before being used separately.

Technical data

Loewe device type:	klang bar5 mr
Part number:	60601D10
Power supply:	AC 100 V – 240 V ~ 50/60 Hz
Audio output power:	220W (RMS)
Power consumption in standby mode:	<0,5W
Frequency response:	60Hz – 20kHz
WLAN supported Standards:	IEEE 802.11a/b/g/n/ac
WLAN power/frequency range:	Maximum power <100 mW at 2400 – 2483,5 MHz Maximum power <100 mW at 5150 - 5350 MHz Maximum power <100 mW at 5470 - 5725 MHz Maximum power <100 mW at 5725 - 5850 MHz
Bluetooth version	V4.2 + EDR
Bluetooth power/frequency range:	Maximum power <10 mW at 2402 - 2480 MHz
Bluetooth protocols:	A2DP, AVRCP
USB playable files:	MP3
Device dimensions (W x H x D):	1200 x 71 x 160 mm
Device weight:	6,5 kg
Ambient temperature:	5° C – 35° C
Relative humidity (non-condensing):	20 – 80%
Video passthrough:	4K Video Pass-through, Dolby Vision, HDR10, HDR10+
Supported Audio formats	HDMI: DTS, DTS-HD, DTS:X, DTS Virtual:X™, Dolby Digital, Dolby Digital plus, Dolby True HD, Dolby Atmos®, LPCM 2ch/Mch, Dolby MAT OPTICAL: DTS, Dolby Digital, LPCM 2ch

Loewe device type:	klang sub5
Part number:	60603D10
Power supply:	AC 100 V – 240 V ~ 50/60 Hz
Audio output power:	180W (RMS)
Power consumption in standby mode:	<0,5W
Frequency response:	35Hz - 150Hz
Device dimensions (W x H x D):	380 x 214 x 380 mm
Device weight:	8,8 kg
Ambient temperature:	5° C – 35° C
Relative humidity (non-condensing):	20 – 80%

Disposal

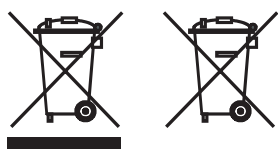

Disposal of used electrical and electronic equipment and batteries.

The crossed-out wheeled bin symbol on the product or its packaging indicates that this product must not be treated as normal household waste, but must be returned to a collection point for the recycling of electrical and electronic equipment and batteries. By helping to properly dispose of this product, you are protecting the environment and the health of your fellow human beings. Improper or incorrect disposal endangers the environment and health. For more information about the recycling of this product, please contact your local authority or your municipal waste disposal service. Attention: The "Pb" sign under the battery symbol indicates that this battery contains lead.